

EX-TRAFIRE® 40SD

Sale discontinued



SIMPLE OPERATION



- + Plug & cut
- + Engineered for hobbyist

HIGHEST APPLICATION FLEXIBILITY

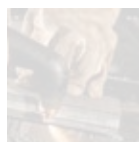

- + Plate thicknesses up to 15 mm +
- + Lightweight, exceptionally portable

EX-TRA PERFORMANCE

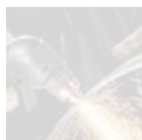

- + Precise cuts
- + Easy operation

BEST COST-EFFECTIVENESS

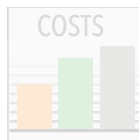

- + Very low investment
- + Lower running costs

Last update of this page: 18/07/2023. See Revision history for details.

EX-TRAFIRE® 40SD

ORDERING INFORMATION

Description	Length	Part No.
MANUAL PLASMA CUTTING SYSTEMS		
EX-TRAFIRE®40SD/CE/1x100-240 V Hand System/FHT-EX40H 4m/H Starter Kit	4 m	EX-2-010-001
EX-TRAFIRE®40SD/CE/1x100-240 V Hand System/FHT-EX40H 5m/H Starter Kit	5 m	EX-2-010-002
EX-TRAFIRE®40SD/CE/1x100-240 V Hand System/FHT-EX40H 7,5m/H Starter Kit	7.5 m	EX-2-010-003
EX-TRAFIRE®40SD/CE/1x100-240 V Hand System/FHT-EX40H 15m/H Starter Kit	15 m	EX-2-010-004
MECHANIZED PLASMA CUTTING SYSTEMS		
EX-TRAFIRE®40SD/CE/1x100-240 V Machine System/FHT-EX40M 4m/M Starter Kit	4 m	EX-2-011-001
EX-TRAFIRE®40SD/CE/1x100-240 V Machine System/FHT-EX40M 5m/M Starter Kit	5 m	EX-2-011-002
EX-TRAFIRE®40SD/CE/1x100-240 V Machine System/FHT-EX40M 7,5m/M Starter Kit	7.5 m	EX-2-011-003
EX-TRAFIRE®40SD/CE/1x100-240 V Machine System/FHT-EX40M 15m/M Starter Kit	15 m	EX-2-011-004
PLASMA POWER SUPPLY UNITS		
EX-TRAFIRE®40SD/CE/1x100-240 V power supply unit (fully-equipped*)		EX-2-001-007

* Fully-equipped=CNC interface & Serial interfaceport (CAN bus)

AVAILABLE BULK PACKS

Description	Pcs	Part No.
Bulk Pack - Electrode - 25 pcs	1	EX-2-434-014
Bulk Pack - Nozzle 30 A - 25 pcs	1	EX-2-435-015
Bulk Pack - Hand (contact) Shield 30 A - 18 pcs	1	EX-2-436-016
Bulk Pack - Machine Shield 30 A - 18 pcs	1	EX-2-437-017
Bulk Pack - Nozzle 40 A - 25 pcs	1	EX-2-435-001
Bulk Pack - Hand (contact) Shield 40 A - 18 pcs	1	EX-2-436-001
Bulk Pack - Machine Shield 40 A - 18 pcs	1	EX-2-437-001

ACCESSORIES

Description	Pcs	Part No.
DN 7.2 ES Quick Connect Plug with female thread G 1/4"	1	EX-0-802-000
DN 7.2 ES Quick Connect Plug with male thread G 1/4"	1	EX-0-802-001
DN 7.2 ES Quick Connect Coupling with male thread G 1/4"	1	EX-0-802-002
Grease 25 ml	1	EX-0-805-001
Filter-EX Compressed Air Filter	1	EX-0-804-001
Filter-EX Air Filter Cartridge	8	EX-0-804-002
Circle cutting guide kit for FHT-EX®30/40H	1	EX-2-801-001

Last update of this page: 18/07/2023. See Revision history for details.

FHT-EX® 40H



VERSATILE AND CAPABLE TORCH



The lightweight FHT-EX®40H hand and machine torches with flexible cables are suitable for a wide range of applications and ideal for mobile use. These torches are optimally designed for use with EX-TRAFIRE®40SD power sources and are suitable for cutting and grid-cutting. They provide precise cutting results on plate thicknesses of up to 15 mm and more.

Thanks to the THERMACUT® Torch Connection System (TCS), changing the torch is a quick and easy process. The powerful torches are the result of decades of experience in the field of plasma cutting. They feature an extremely robust and durable design in which all consumables can be replaced quickly and easily.

BENEFITS

- An ergonomically shaped handheld torch that reduces fatigue
- Compact and particularly flexible for handheld applications, even if difficult to reach
- Long lifetime thanks to a 100 % duty cycle at 25 A
- Ideal for plate thicknesses of up to 15 mm and more with high power reserves
- Consumables with an extended lifetime
- Quick and tool-free replacement of consumables
- Piercing max. 10 mm
- Specially designed for use with the EX-TRAFIRE®40SD power supply

Last update of this page: 09/06/2021. See Revision history for details.

FHT-EX® 40H

HAND TORCH ASSEMBLY



Item	Part No.	Description	Pcs
1.	EX-2-133-000	DEMO FHT-EX®40H Hand Torch Assembly/TCS13	1
	EX-2-130-001	FHT-EX®40H Hand Torch Assembly w/o consumables/4m Lead/TCS13	1
	EX-2-101-003	FHT-EX®40H Hand Torch Assembly w/o consumables/5m Lead/TCS13	1
	EX-2-131-005	FHT-EX®40H Hand Torch Assembly w/o consumables/7.5m Lead/TCS13	1
	EX-2-106-007	FHT-EX®40H Hand Torch Assembly w/o consumables/15m Lead/TCS13	1
2.	EX-0-321-003	Latch with Key Assembly	1

LATCH WITH KEY IS NOT CONTENT OF TORCHES ABOVE. IF YOU NEED IT, YOU HAVE TO ORDER SEPARATELY.

Last update of this page: 09/06/2021. See Revision history for details.

FHT-EX® 40H

HAND TORCH COMPONENTS



Item	Part No.	Description	Pcs	Item	Part No.	Description	Pcs
1.	EX-2-328-001	Hand Torch Lead Replacement Kit 4m Lead/TCS13	1	10.	EX-2-304-020	Hand Torch PIP Pins Replacement Kit (with Wires)	1
	EX-2-331-002	Hand Torch Lead Replacement Kit 5m Lead/TCS13	1	11.	EX-2-302-009	Hand Torch Body FHT-EX®40H	1
	EX-2-329-003	Hand Torch Lead Replacement Kit 7.5m Lead/TCS13	1	12.	EX-0-319-011	Shrink Tube	1
	EX-2-336-004	Hand Torch Lead Replacement Kit 15m Lead/TCS13	1	13.	EX-2-308-012	Hand Torch Handle Kit	1
2.	EX-5-318-001	TCS Plug Spring Strain Relief	1	14.	EX-5-310-014	Trigger Guard	1
3.	EX-0-325-015	TCS Clam Shell Screw	1	15.	EX-5-309-013	Trigger	1
4.	EX-0-325-002	TCS Clam Shell Upper	1	16.	EX-5-313-018	Safety Trigger Replacement Kit	1
5.	EX-0-325-001	TCS Clam Shell Lower	1	17.	EX-2-314-015	Hand Torch Handle Replacement Kit	1
6.	EX-0-325-010	Retaining Ring (Outer circlip ring)	1	18.	EX-2-427-010	Electrode Wrench FHT-EX®30/40	1
7.	EX-0-325-009	O-Ring (fitted in the TCS plug)	1	19.	EX-0-321-003	Latch with Key Assembly	1
8.	EX-0-325-005	Male Crimp Pin for TCS Plug	1	20.	EX-0-323-001	TCS13 Plug Body	1
9.	EX-0-319-021	Insulating Teflon Tube	1	NS	EX-2-431-014	O-Ring (fitted on the torch body)	2

ON DEMAND - WE DO NOT KEEP THESE PARTS IN STOCK, COST IS SET ACCORDING TO THE ORDERED QUANTITY, DELIVERY TIME MAY DIFFER FROM STANDARD PRODUCT

Last update of this page: 24/01/2022. See Revision history for details.

FHT-EX® 40M

MACHINE TORCH ASSEMBLY



Item	Part No.	Description	Pcs
1.	EX-2-233-000	DEMO FHT-EX®40M Machine Torch Assembly/TCS13	1
	EX-2-235-001	FHT-EX®40M Machine Torch Assembly w/o consumables/4m Lead/TCS13	1
	EX-2-202-003	FHT-EX®40M Machine Torch Assembly w/o consumables/5m Lead/TCS13	1
	EX-2-236-005	FHT-EX®40M Machine Torch Assembly w/o consumables/7.5m Lead/TCS13	1
	EX-2-207-007	FHT-EX®40M Machine Torch Assembly w/o consumables/15m Lead/TCS13	1
2.	EX-0-321-003	Latch with Key Assembly	1

LATCH WITH KEY IS NOT CONTENT OF TORCHES ABOVE. IF YOU NEED IT, YOU HAVE TO ORDER SEPARATELY.

Last update of this page: 09/06/2021. See Revision history for details.

FHT-EX® 40M

MACHINE TORCH COMPONENTS

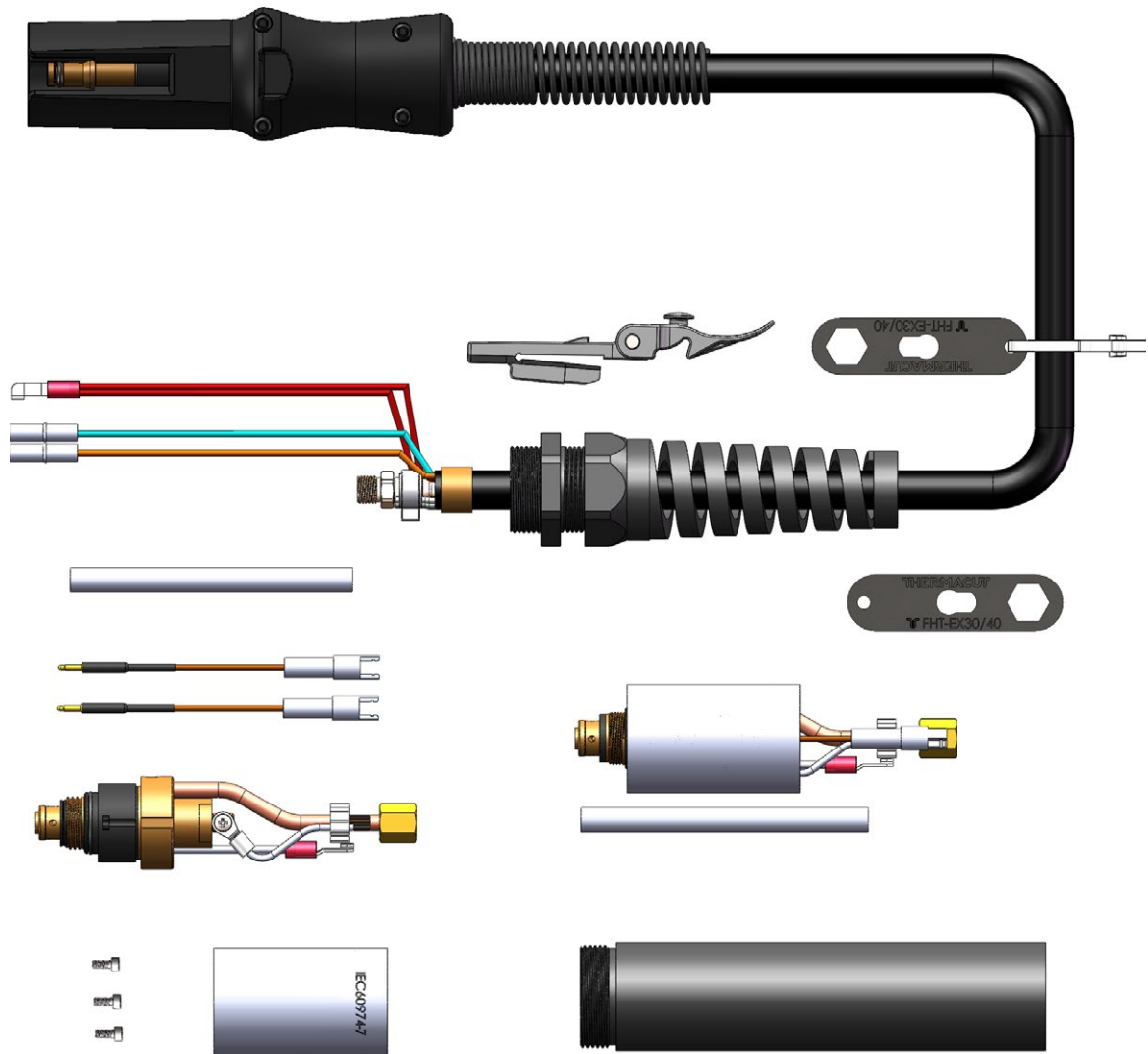

Item	Part No.	Description	Pcs	Item	Part No.	Description	Pcs
1.	EX-2-301-010	Machine Torch Body Assembly FHT-EX®40M	1	6.	EX-0-325-001	TCS Clam Shell Lower	1
1a.	EX-2-301-011	Machine Torch Body FHT-EX®40M	1	7.	EX-0-325-010	Retaining Ring (Outer Circlip Ring)	1
1b.	EX-2-304-021	Machine Torch PIP Pins Replacement Kit (with Wires)	1	8.	EX-0-325-009	O-Ring (fitted in the TCS plug)	1
1c.	EX-2-306-022	Torch Mounting Sleeve (incl. screws)	1	9.	EX-0-325-005	Male Crimp Pin for TCS Plug	1
2.	EX-2-326-005	Machine Torch Lead Replacement Kit 4m Lead/TCS13	1	10.	EX-2-306-023	Torch Positioning Sleeve	1
	EX-2-352-006	Machine Torch Lead Replacement Kit 5m Lead/TCS13	1	11.	EX-2-372-001	Torch Mounting Screw	1
	EX-2-327-007	Machine Torch Lead Replacement Kit 7.5m Lead/TCS13	1	12.	EX-0-319-021	Insulating Teflon Tube	1
	EX-2-357-008	Machine Torch Lead Replacement Kit 15m Lead/TCS13	1	13.	EX-2-427-010	Electrode Wrench FHT-EX®40	1
3.	EX-5-318-001	TCS Plug Spring Strain Relief	1	14.	EX-0-321-003	Latch with Key Assembly	1
4.	EX-0-325-015	TCS Clam Shell Screw	1	15.	EX-0-323-001	TCS13 Plug Body	1
5.	EX-0-325-002	TCS Clam Shell Upper	1	NS	EX-2-431-014	O-Ring (fitted on the torch body)	2

ON DEMAND - WE DO NOT KEEP THESE PARTS IN STOCK, COST IS SET ACCORDING TO THE ORDERED QUANTITY, DELIVERY TIME MAY DIFFER FROM STANDARD PRODUCT

Last update of this page: 24/01/2022. See Revision history for details.

CONSUMABLES

HAND / MACHINE TORCH CONSUMABLES

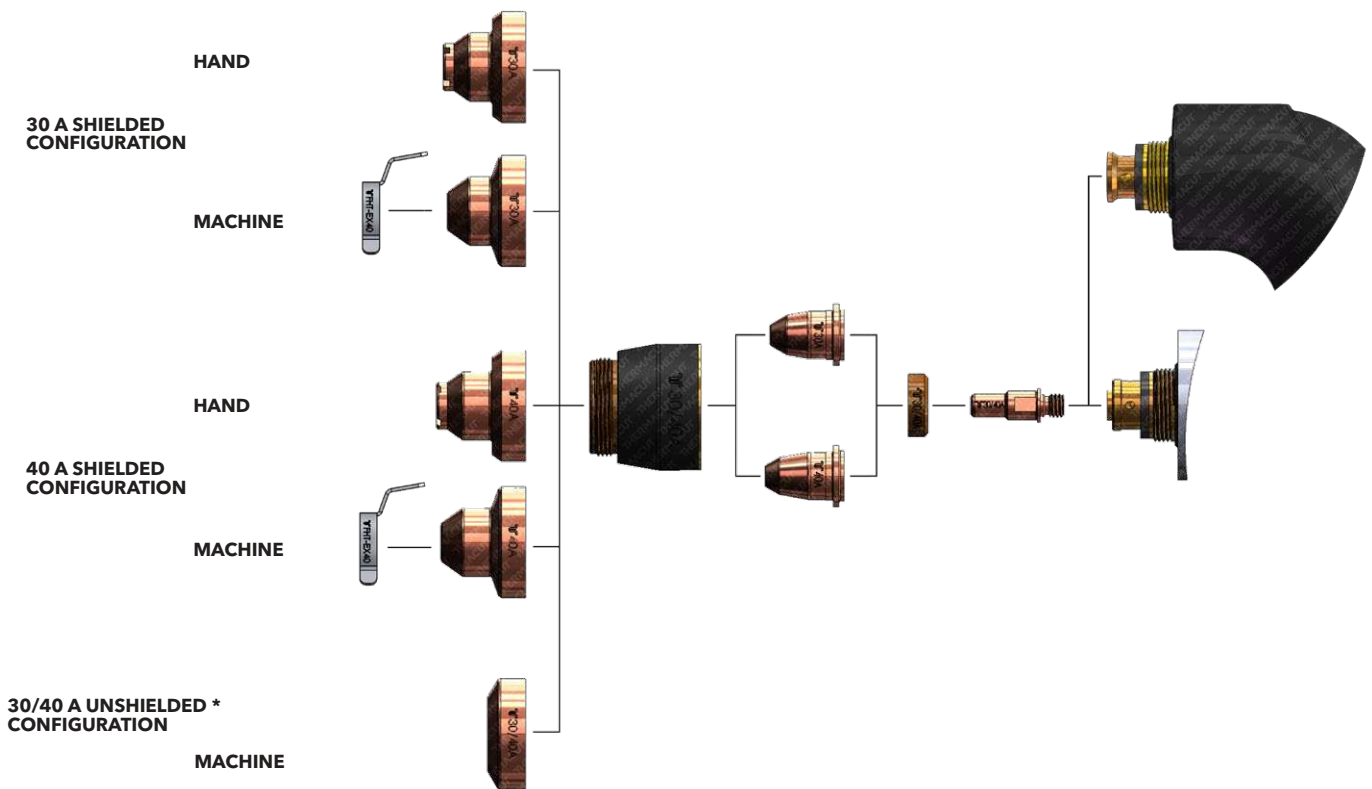

Item	Part No.	Description	Pcs	Item	Part No.	Description	Pcs
1.	EX-2-401-001	Electrode	5	9.	EX-2-421-001	Machine Shield 40 A	1
2.	EX-2-404-002	Swirl Ring	2	10.	EX-2-423-107	Deflector	1
3.	EX-2-409-003	Nozzle 30 A 0.8 mm	5	NS	EX-2-434-014	Bulk Pack - Electrode - 25 pcs	1
4.	EX-2-409-001	Nozzle 40 A 0.9 mm	5	NS	EX-2-435-015	Bulk Pack - Nozzle 30 A 0.8 mm - 25 pcs	1
5.	EX-2-415-004	Nozzle Retaining Cap (Protection Cap)	1	NS	EX-2-435-001	Bulk Pack - Nozzle 40 A 0.9 mm - 25 pcs	1
6.	EX-2-419-005	Hand Shield 30 A	1	NS	EX-2-437-017	Bulk Pack - Machine Shield 30 A - 18 pcs	1
7.	EX-2-421-006	Machine Shield 30 A	1	NS	EX-2-437-001	Bulk Pack - Machine Shield 40 A - 18 pcs	1
8.	EX-2-419-001	Hand Shield 40 A	1	11.	EX-2-428-011	IHS Ohmic Clip	1

NS NOT SHOWN IN THE PICTURE

***** IN COUNTRIES FOLLOWING CE STANDARDS, UNSHIELDED CONSUMABLE CONFIGURATION MAY ONLY BE USED IN MECHANIZED TORCH APPLICATIONS.
ONLY FOR EX-TRAFIRE®40SD

Last update of this page: 09/06/2021. See Revision history for details.